

Window Schedule

CODE	D	x	W
W3A	1200	x	860
W4A	1500	x	860
W5A	1890	x	860
W8B	1200	x	1820
W9A	1500	x	1860
W10A	1890	x	1860

OBS OBSCURED  
XO UNLESS NOTED O'WISE

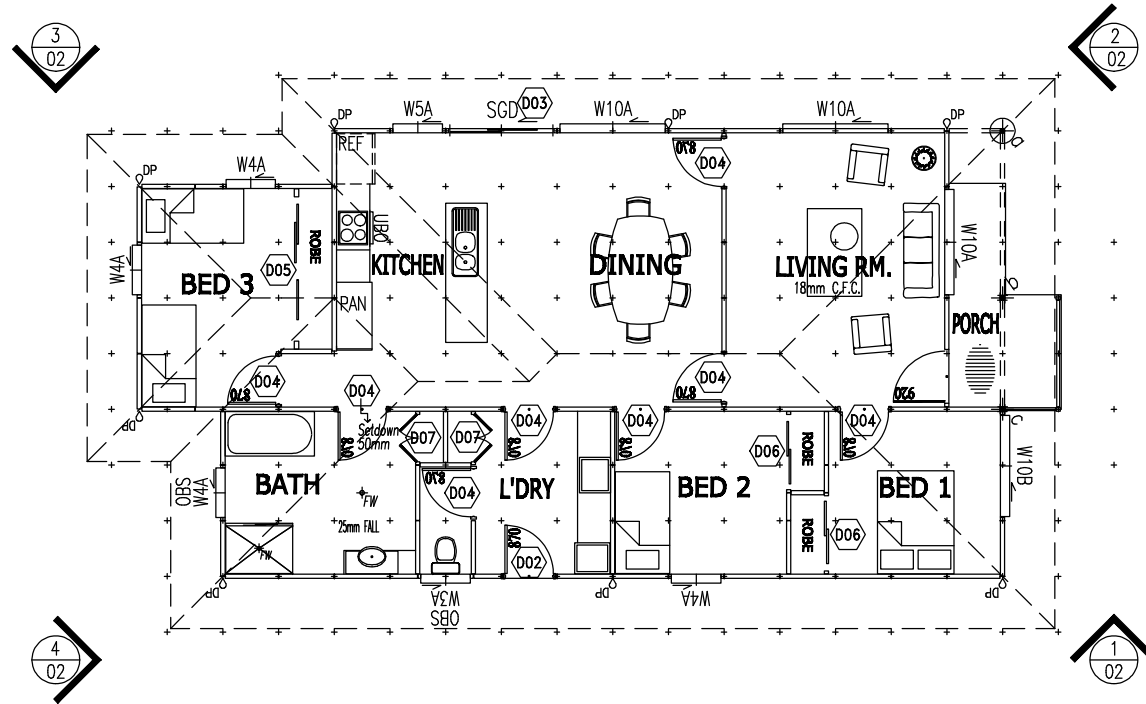

Door Schedule

NO.	DESCRIPTION	METRIC SIZE (DxW)	NOTES
D01	EXT. WOOD MADISON 'PMAD104'	2040 x 920	ENTRY
D02	EXT. WOOD SOLID, DURACOAT	2040 x 870	
D03	ALUM. FRAMED SLIDING GLASS DOOR w/ SCREEN	2090 x 1810	
D04	INTERNAL WOOD, READICOTE	2040 x 870	
D05	INT. SLIDING ROBE, READICOTE (3 LEAF)	2040 x 3/870	2087x2732 FR.
D06	INT. SLIDING ROBE, READICOTE (2 LEAF)	2040 x 2/620	2087x1343 FR.
D07	INT. WOOD, READICOTE DOUBLE (C'PBD)	2040 x 2/410	

FLOOR PLAN

FLOOR AREAS	
ENCLOSED HABITABLE AREA	= 111.00 m <sup>2</sup>
+ PORCH	= 6.00 m <sup>2</sup>
<b>TOTAL</b>	<b>= 117.00 m<sup>2</sup></b>



"BUILDING SOLUTIONS FOR THE WORLD"  
QUALITY APPROVED TO AS/NZS ISO9001

**FORCE 10 INTERNATIONAL PTY LTD**  
63 FACTORY ROAD, OXLEY  
QUEENSLAND, AUSTRALIA 4075

PH. +61 7 33795200 FX. +61 7 33795211  
email:- info@force10.com.au  
web:- http://www.force10.com.au  
THE FORCE 10 ENGINEERED BUILDING SYSTEM IS PROTECTED BY WORLDWIDE PATENTS. THIS DRAWING MAY NOT BE COPIED OR REPRODUCED IN PART OR WHOLE WITHOUT WRITTEN CONSENT FROM FORCE 10 INTL. PTY LTD.

**CONTENTS**  
FLOOR PLAN  
ELEVATIONS  
PANEL, BRACING  
FLOOR FRAMING  
STUMP HEIGHTS  
FLOOR SHT. LAYOUT  
TRUSS / PURLIN  
PERSPECTIVE

PG  
01  
02  
03  
04  
05  
06  
07  
08

**CONTENTS**  
PG

PG

D	KS	06/02/07
C	KS	22/01/07
B	KS	16/10/06
A	KS	25/09/06
REV	BY	DATE

DRAWING REVISIONS

**DRAWN BY : KS**  
**DATE : 10-10-06**  
**CHECKED :**  
**SCALE : 1:100 @ A3**

**PROJECT**  
**TENDER # : T1394**  
**JOB# : 060470**  
**DRAWING # : 060470-01**

D